

# Pariseau Farm Dump Site Okanogan County



## Proposed Delisting from Hazardous Sites List Available for Public Review and Comment

Ecology is proposing to remove the Pariseau Farm Dump site (Site) from its Hazardous Sites List. The Site is located approximately 1.5-miles northeast of Brewster off of Highway 97. The Site is currently ranked a "1" on the list. A rank of "1" is the highest level of concern compared to other sites on the list, and a rank of "5" is the lowest.

### Site Background

The Site is located in a drainage area within an operating orchard. Numerous visits to the site in 1987 and 1988 identified a burn dump for household trash, orchard waste and, of greater concern, as a pesticide disposal site. The major contaminants of concern included pesticides, petroleum hydrocarbons, and petroleum-related semi-volatile organic compounds. More than likely, throughout the years, it became a general all-purpose dump site for all sorts of waste. It is unknown how long the site was used as a dump. As such, it became necessary to adequately investigate the site to determine potential contaminants.

A Site Hazard Assessment (SHA) was conducted at the site in 1991. During the SHA, soil samples were collected from the dump site, as well as farther down the drainage area. Analytical results from the soil samples collected identified levels of DDE, Endosulfan Sulfate, Endosulfan-I and II, and Endrin.

No applicable soil cleanup levels existed for the identified chemicals in 1991. The Model Toxics Control Act (MTCA) Method B soil cleanup values went into effect in 1991, and were substantially reorganized in 2001. The levels of contaminants identified from soil samples collected in 1991 are significantly below the MTCA Method B soil cleanup values.

Currently, the site is fenced and is posted with signage that states dumping is prohibited. The site is free of waste and monitored regularly to prevent dumping.

Based upon a review of the SHA and current applicable soil cleanup regulations, Ecology has determined this site no longer poses a threat to human health and the environment and has recommended removing the site from the Hazardous Sites List.

### Request for Public Comments

Before a site can be taken off the list, Ecology needs your input! Therefore, Ecology's proposal to delist the Pariseau Farm Dump site is now open for a 30-day public comment period, between August 10, 2006 and September 11, 2006.

Documents pertinent to the delisting are available at the repositories listed in the box to the right. Please submit your written comments to Brianne Harcourt, Site Manager, at the Ecology address listed in the box to the right. Ecology will review and respond to all comments received.

### FACT SHEET August 2006

#### For technical questions:

**Brianne Harcourt**  
Toxics Cleanup Program  
Ecology Central Regional Office  
15 W Yakima Ave., Suite 200  
Yakima, WA 98902  
(509) 454-7835  
brha461@ecy.wa.gov

#### For other questions or to be placed the site mailing list:

**Frosti Smith**  
Toxics Cleanup Program  
Ecology Central Regional Office  
15 W Yakima Ave., Suite 200  
Yakima, WA 98902  
(509) 454-7841  
fsmi461@ecy.wa.gov

#### Public Comment Period:

August 10, 2006 through  
September 11, 2006

#### Documents are available for public review at:

Ecology Central Regional Office  
address listed above

Brewster Public Library  
108 3rd Street  
Brewster, WA 98812

Ecology's Toxics Cleanup Website:  
[http://www.ecy.wa.gov/programs/tcp/sites/pariseau/pariseau\\_hp.htm](http://www.ecy.wa.gov/programs/tcp/sites/pariseau/pariseau_hp.htm)

#### Para asistencia bilingue:

**Gregory Bohn**  
Ecology Central Regional Office  
15 W Yakima Ave., Suite 200  
Yakima, WA 98902  
(509) 575-2490  
gtboh461@ecy.wa.gov



*Ecology is an Equal Opportunity Employer*

*Ecology Publication Number 06-09-017*

*If you need this publication in an alternate format, please call the Toxics Cleanup Program at (509) 575-2490. Persons with hearing loss can call 711 for Washington Relay Service. Persons with a speech disability can call 877-833-6341.*

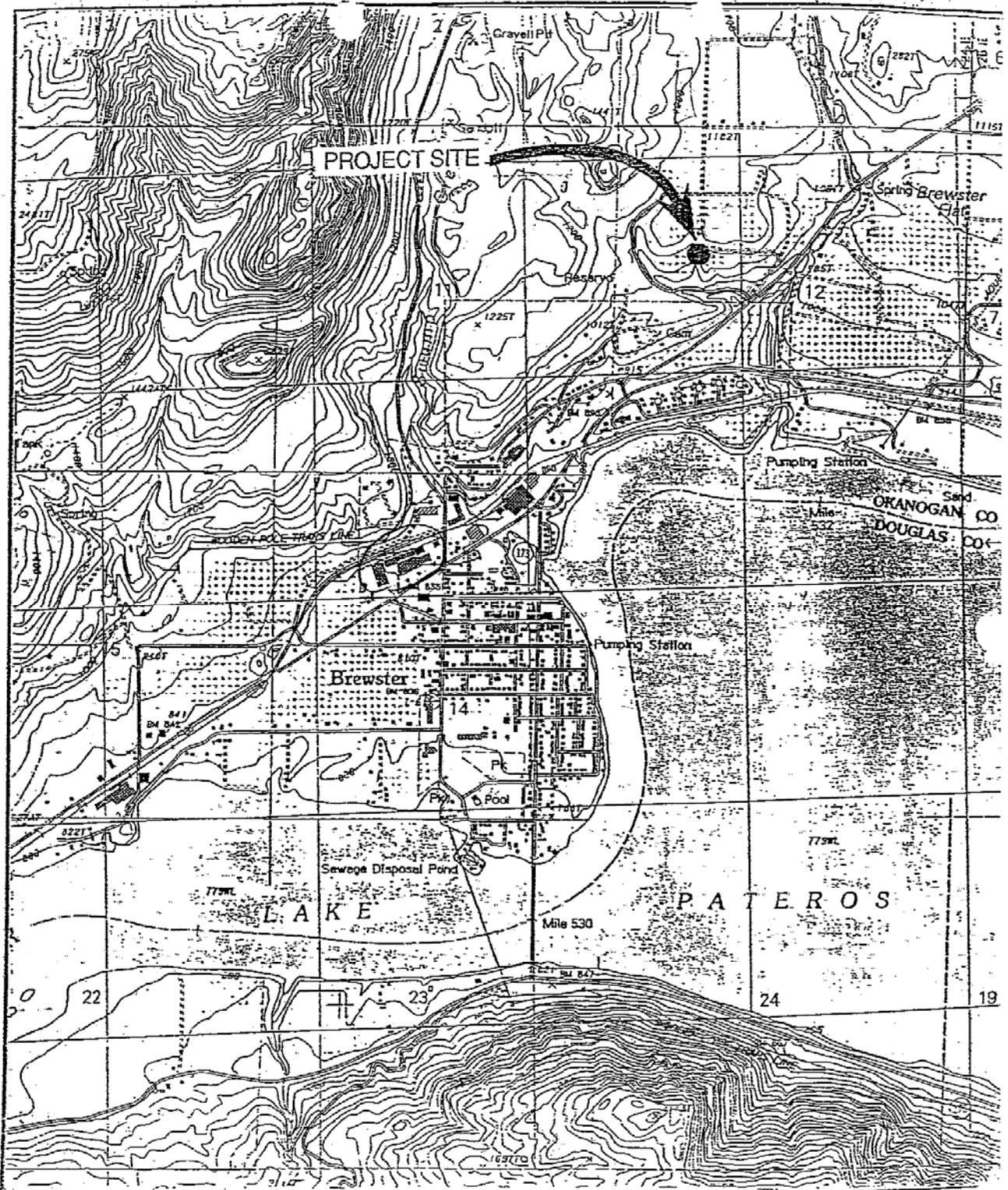
# Pariseau Farms Site Location Map

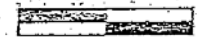
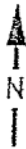

 <p>0' 2000'</p>	 <p>N</p>  <p>WASHINGTON</p>	<p>EXHIBIT 2.2 TOPOGRAPHIC MAP</p> <hr/> <p>PARISEAU FARM</p>	
---	--	---	---