

Bothell Landing Cleanup Site

CONTACTS & INFORMATION

Comments Accepted

April 12— May 11, 2018

Submit comments to:

Jerome Cruz - Site Manager

Toxics Cleanup Program
3190 160th Ave S.E.

Bellevue, WA 98008

Phone: (425) 649-7094

E-mail: jerome.cruz@ecy.wa.gov

Please specify “**Bothell Former Hertz**” in your comment.

Document review locations:

Bothell Public Library

18215 98th Ave NE

Bothell, WA 98011

Phone: (425) 486-7811

City of Bothell

18415 101st Ave NE

Bothell, WA 98011

Phone: (425) 806-6100

Department of Ecology Northwest Regional Office

3190 160th Ave S.E.

Bellevue, WA 98008

Call Sally Perkins for an
appointment: (425) 649-7190

Bothell Landing Website:

<https://fortress.wa.gov/ecy/gsp/Sitepage.aspx?csid=3013>

Ultra Custom Care Cleaners Website:

<https://fortress.wa.gov/ecy/gsp/Sitepage.aspx?csid=3172>

Background

The Washington State Department of Ecology (Ecology) and the City of Bothell will enter into a new agreement called an Agreed Order to clean up the Bothell Landing site. The site is generally located at the intersection of Woodinville Drive / SR 522 and Bothell Way NE/ former SR 527, in Bothell, Washington.

A strip mall, restaurants, and historic gas stations with multiple abandoned underground storage tanks (USTs) formerly occupied the site. Petroleum hydrocarbons associated with the service stations were found in soil and groundwater. Five USTs were removed during construction of the park in 1998. Chlorinated solvents (chemicals commonly associated with dry cleaners) were found in groundwater. These came from the Ultra Custom Care Cleaners site, which is being cleaned up separately.

The city acquired properties on which the site lies in 2008 for construction of the SR 522 realignment. They entered into an Agreed Order with Ecology in 2009 to investigate the site.

Interim action soil cleanups of petroleum hydrocarbons were conducted in 2010, 2013, 2014, 2015, and 2017.

Public Comments Invited

You are invited to comment on the following documents:

- **Draft Agreed Order.** A legal agreement to clean up the site.
- **Draft Remedial Investigation/Feasibility Study (RI/FS) Report.** Describes the extent of contamination at the site and completed interim actions, evaluates cleanup options, and proposes the preferred cleanup remedy.
- **Draft Cleanup Action Plan (DCAP).** Describes the proposed site cleanup remedy and how it will be implemented.
- **Draft Compliance Monitoring Plan.** Describes how groundwater will be monitored to establish compliance with state cleanup regulations.
- **Updated Public Participation Plan.** Describes how the public can stay informed and give input on activities at the site in the future.
- **State Environmental Policy Act (SEPA) Checklist and Determination of Nonsignificance.** Ecology has reviewed the project and determined it is not likely to cause significant negative effects to the environment or local community.

The 2009 Agreed Order (No. DE 6294) to conduct the RI/FS and write the DCAP has been completed and closed out. The new Agreed Order for cleanup will be finalized after Ecology has reviewed all the public comments and determined that no significant changes to the documents are necessary.



Special accommodations:

To request ADA accommodation for disabilities, or printed materials in a format for the visually impaired, call Ecology at (360) 407-7668 or visit <http://ecology.wa.gov/accessibility>

People with impaired hearing may call Washington Relay Service at 711. Persons with speech disability may call TTY at 877-833-6341.

Facility Site ID #: 73975762

Cleanup Site ID#: 3013

Chemicals of Concern

Chemicals of concern remaining after the interim action soil cleanups are:

- In soil: Gasoline range petroleum hydrocarbons and benzene
- In groundwater: Arsenic

Proposed Cleanup

A Draft Cleanup Action Plan (DCAP) was completed in 2017. The selected remedy in the DCAP consists of a combination of

- excavation of contaminated soils (already completed as interim actions),
- engineering controls (capping under roadway),
- institutional controls (including property environmental covenants) restricting access to soil and groundwater, and
- compliance groundwater monitoring.

Site Parcels Reconfigured

The original 2.8-acre Bothell Landing parcel no longer exists in its original configuration. The city currently owns that land, which now includes public rights-of-way for the realigned SR 522 and Bothell Way NE.

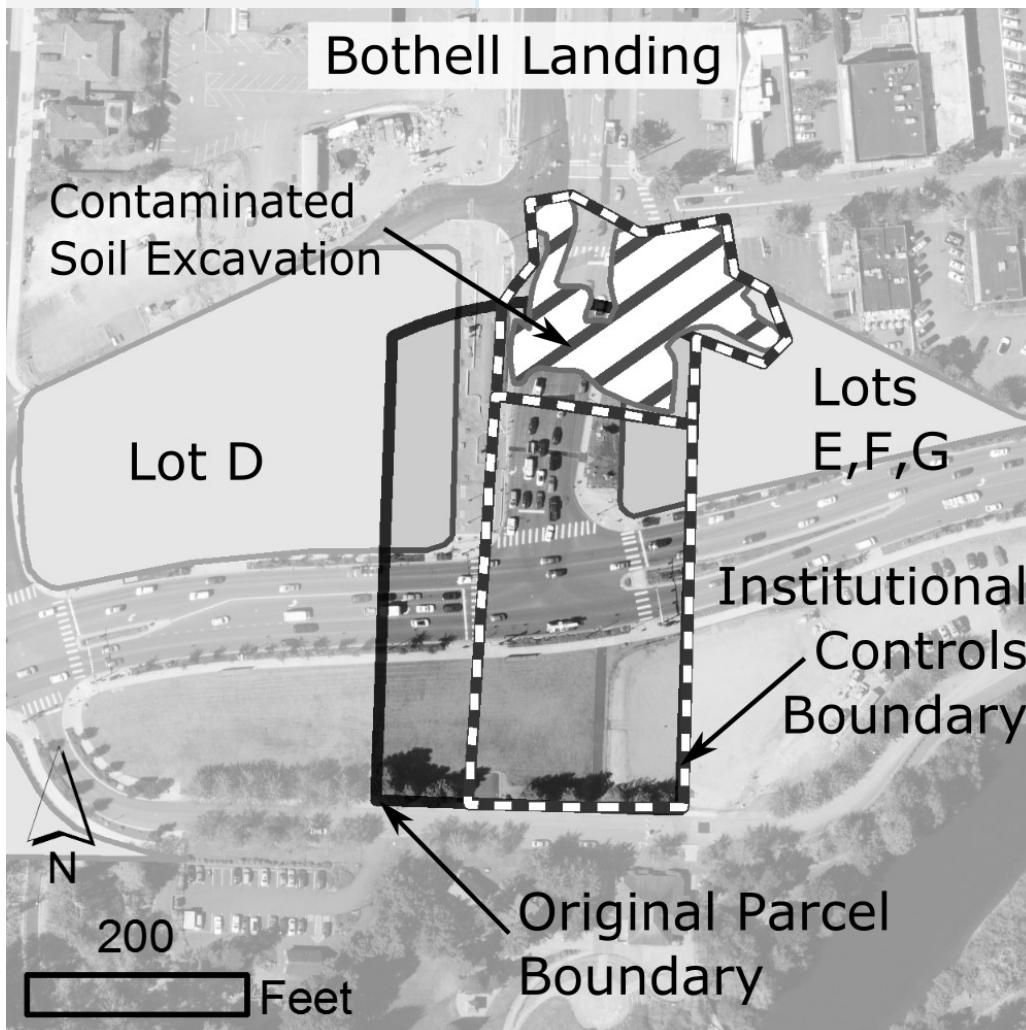

The city property also includes portions of three newly formed parcels on the east, west, and south sides of the new "T" intersection. Current city-owned parcels that now contain a portion of the former 2.8-acre Bothell Landing parcel are:

- Northeast corner – Lots E, F, G
- Northwest corner – Lot D
- South part – city park land (Park at Bothell Landing)



Toxics Cleanup Program, Northwest Region

3190 160th Avenue SE

Bellevue, WA 98008-5452

Public comment invited for 3 Bothell cleanup sites

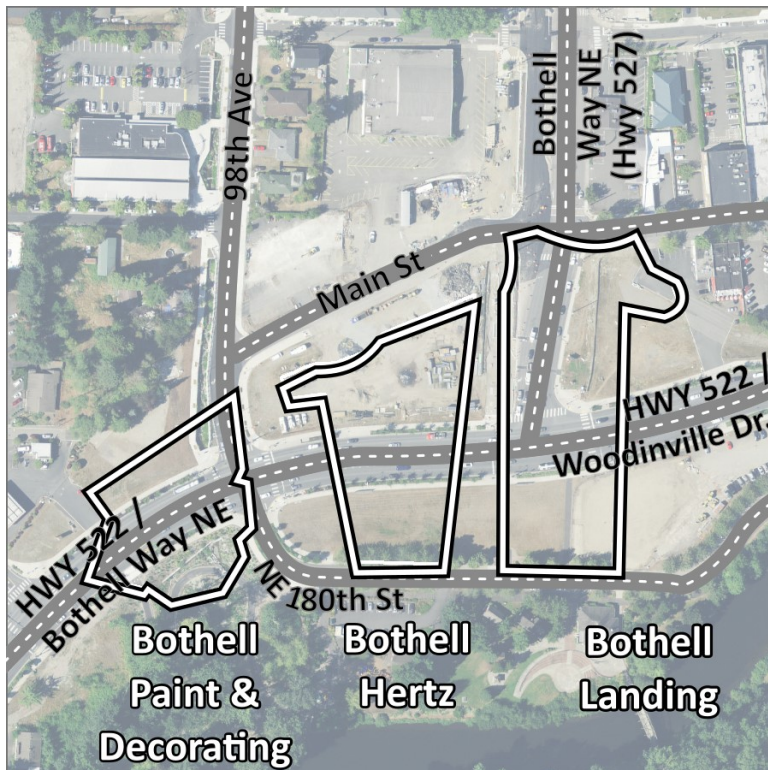

Public Comment Period:
April 12—May 11, 2018

- **Bothell Paint and Decorating**
- **Bothell Former Hertz**
- **Bothell Landing**

Para obtener más información sobre esta limpieza del sitio Bothell Landing, Bothell Former Hertz, o Bothell Paint and Decorating en español o traducciones de otros materiales, favor de comunicarse con Gretchen Newman al teléfono (360) 407-6097 o por correo electrónico al preguntas@ecy.wa.gov. Favor de hacer referencia al Sitio Bothell Landing, Bothell Former Hertz, o Bothell Paint and Decorating.