

Fact Sheet: Removal of Vehicle Mercury Switch Assemblies

Hazardous Waste and Toxics Reduction Program

Remove all mercury switch assemblies from vehicles as soon as possible after they enter the facility. Removal of mercury switches is quick and easy. Auto recyclers throughout Washington state report it takes approximately 30–60 seconds to remove the entire mercury light switch assembly. ABS G-Force Sensors take 5–7 minutes. Tools found most useful in doing the job include wire cutters, screwdriver, ratchet, wrench, pry bar, and pliers.

Mercury Convenience Light Switches

Any vehicle equipped with a convenience light in the hood and/or trunk is likely to have mercury switches if it's a 2002 or older Ford or GM, or a 1998 or older Chrysler.

Removing mercury hood and trunk convenience lights

1. Lift the hood or trunk and locate the small mercury lighting switch assembly. Refer to the [Auto Mercury Switch Removal poster](#)¹ that lists the make/model, year, and location of switch, (e.g., hood or trunk).
2. Disconnect the battery.
3. Find the small light fixture on the underside of the hood or trunk.
4. Cut the wires leading to the device.
5. Remove the light assembly from vehicle. Unscrew, unbolt, or pry the light fixture from the hood/trunk.
6. Place light assembly in labeled container. You may remove as much of the device as possible to make more room in the container.

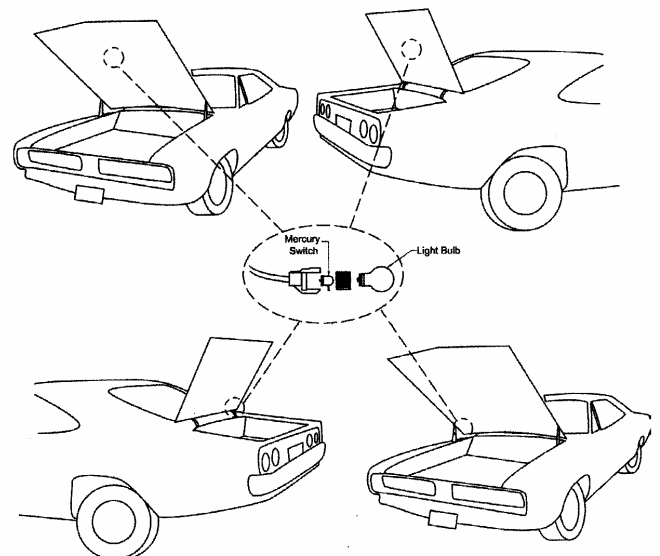

Figure 1. Removal of hood and trunk convenience light switches

Please note: In some instances (such as many GM vehicles), leaving the assembly intact and removing the pellet may be easier than removing the entire assembly.

¹ <https://apps.ecology.wa.gov/publications/SummaryPages/0704006.html>

Mercury ABS G-Force Sensors

Check for the mercury ABS G-Force Sensor on 4-wheel drive cars and trucks listed on the Auto Mercury Switch Removal Poster¹ or in the [Removal Guide for Vehicle Mercury Light Switches & ABS G-Force Sensors](#).² Most ABS sensors contain three mercury switch pellets embedded in a solid plastic component (leave the pellets in the component part).

The sensor will be located on the drive tunnel in one of three places:

1. Directly below the driver seat on the left frame rail.
2. Below the rear seat on the floor pan.
3. Below the center seat on the right front wheel apron.

Removing the ABS Sensor takes 5–7 minutes if the vehicle is on a lift to drain fluids and 15 minutes if vehicle is not on a lift. The removal procedure varies depending on the vehicle model, but in general the procedure is:

Removing mercury ABS G-Force Sensors

1. Disconnect the battery.
2. Locate the ABS G-Force Sensor on the vehicle.
3. Disconnect the harness connector.
4. Remove bolts to release sensor.
5. Remove sensor. **Please note:** Do not attempt to remove pellets from mercury ABS G-Force Sensors.
6. Place the entire assembly in a labeled container with the light switch assemblies.

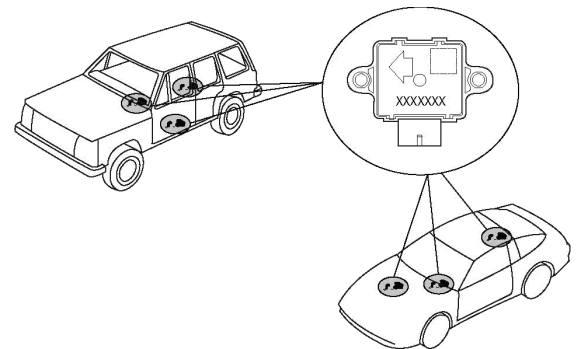

Figure 2. Removal of ABS G-force sensor switches.

For More Information

Visit [our automotive mercury switch removal program webpage](#)³ for current contact information.

ADA Accessibility

To request an ADA accommodation, contact Ecology by phone at 360-407-6700 or email at hwtrpubs@ecy.wa.gov, or visit ecology.wa.gov/accessibility. For Relay Service or TTY call 711 or 877-833-6341.

² <https://apps.ecology.wa.gov/publications/SummaryPages/0504024.html>

³ ecology.wa.gov/autoswitch