

Cleanup Construction is Underway at the Everett Smelter Site

The Department of Ecology (Ecology) has begun removing contaminated soil from an area of the Everett Smelter Cleanup Site. This work is focused on two areas of the cleanup site, one north and one south of Broadway (map on page 2). Work will continue until early March.

In addition to the cleanup work, Ecology will sample two City-owned parks, American Legion Memorial and Wiggums Hollow Parks. Results for the park sampling should be available in the spring of 2013.

What Happens Next?

Cleanup:

- Clearcreek, Ecology's contractor, continues removing contaminated soil from properties on Hawthorne Street and Balsam Lane.
- If your property is scheduled for cleanup in 2011, you will receive a call at least one week before work begins on your property.
- Ecology will meet with property owners scheduled for cleanup work in 2012 in November and December 2011.
- Three construction information signs are located in the cleanup area at 2709 5th Street, 2901 Butler and on the 700 block of Hawthorne. Ecology will keep flyers in sign boxes with the latest project information.

Sampling:

- Ecology's consultant will map landscape features and locate utility lines on City park properties in late November 2011.
- Park sampling is scheduled for December 2011 and January 2012.
- Ecology will begin mapping and sampling another group of properties in February 2012.
- If your property is scheduled for sampling, you will receive a letter and access agreement in the mail this winter. Ecology will not sample your property without your permission.
- Results of the February 2012 sampling will be available in November 2012.

Everett Smelter Cleanup Everett, WA

Cleanup Construction Underway at the Everett Smelter Site

Facility Site ID #: 2744

If you need this publication in an alternative format call reception at 425-649-7000. Persons with hearing loss, call 711 for Washington Relay Service. Persons with a speech disability, call 877-833-6341.

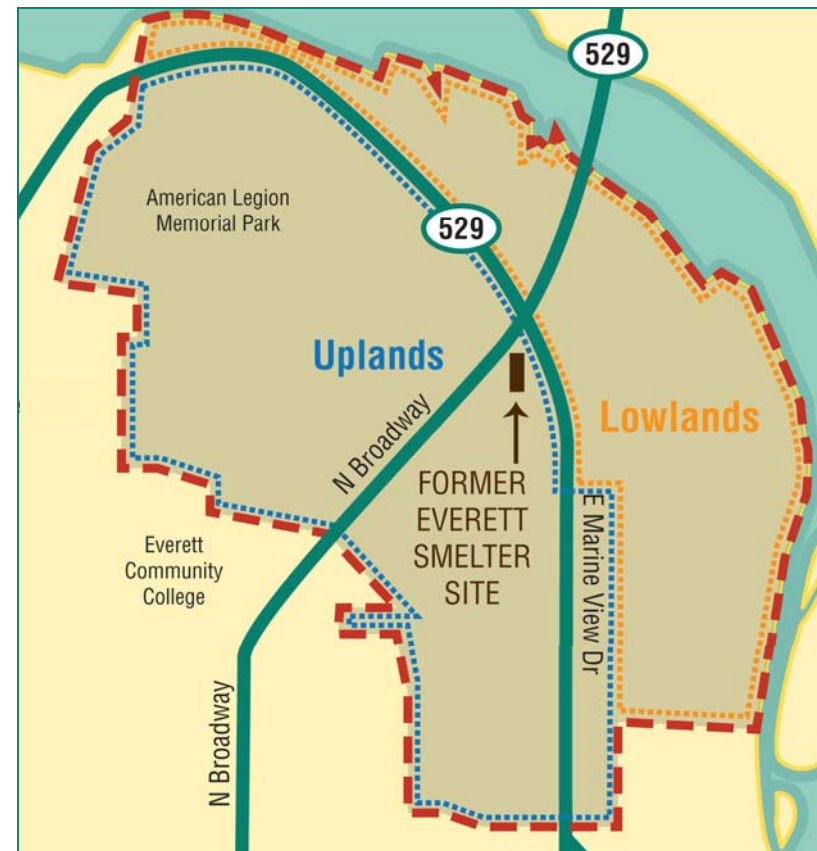

Everett Smelter Cleanup Site, Everett

For More Information

General Questions and Public Involvement

Meg Bommarito, Project Manager
 WA Department of Ecology
 Northwest Regional Office
 Toxics Cleanup Program
 3190 160th Street
 Bellevue, WA 98008
 Phone: (425) 649-7256 or
 (425) 412-0372 (cell)
 Email: Meg.Bommarito@ecy.wa.gov

Technical or Construction Questions:

Frank Reinart, Upland Site Manager
 Phone: (425) 649-7287 or
 (425) 530-5169
 E-mail: Frank.Reinart@ecy.wa.gov

Local Information Line

(425) 530-5169*
 *This number will be checked daily and on weekends. The project coordinator or site manager will return your call within 24 hours.

Health Questions:

Jim White
 Washington Department of Health
 Phone: (360) 236-3192 or
 Toll free 1-877-485-7316
 Email: Jim.W.White@doh.wa.gov

Health Information about arsenic

<http://www.doh.wa.gov/ehp/oeas/pubs/arsenic.pdf>
and lead
<http://www.doh.wa.gov/ehp/Lead/default.htm>

Ecology's Web site

http://www.ecy.wa.gov/programs/tcp/sites_brochure/asarco/es_main.html

Facility Site ID #2744

2011 Cleanup Activity

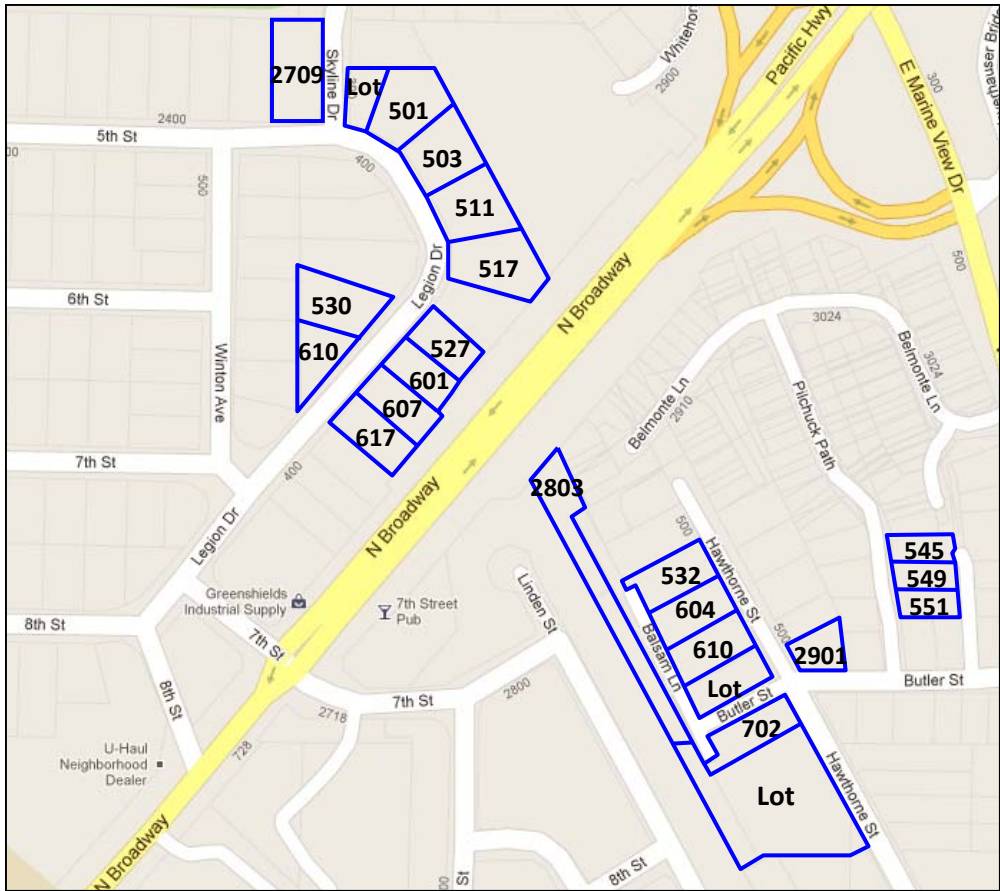

Key
Property scheduled for cleanup in 2011 =

2011 Sampling Activity

Key
Property sampled in 2011 =



Background

The Asarco smelter, which operated in Everett in the early 1900s, caused widespread arsenic and lead contamination in northeast Everett. In addition to contamination left behind on the old smelter property, particles from the stacks settled on the surrounding areas, contaminating soil.

Ecology managed the cleanup of the most highly contaminated properties from 1999-2007. In 2009, Ecology received funding through a bankruptcy settlement with Asarco to continue with cleanup efforts. Ecology began sampling properties using this funding in 2010.

Protecting Your Family from Contamination

The most highly contaminated soil at the Everett Smelter site has already been removed or covered with buildings or pavement. However, soil with lower levels of arsenic and lead remains on a lot of properties and may be a health hazard over time unless you minimize your exposure. Until cleanup can be completed, Ecology recommends that you take the actions (box below) to protect your family from contamination that might be on your property.

Take these steps to protect your family from contaminated soil!

	<p>Wash your hands well before eating and after working or playing in the soil. Use a scrub brush to clean dirt from under your nails.</p>		<p>Mop, damp dust and vacuum often to remove dirt tracked in from outside.</p>
	<p>Wash fruits and vegetables grown at home before eating them to remove soil that may be on the surface. Grow vegetables in raised beds with clean soil.</p>		<p>Leave your shoes at the door or outside so you don't track dirt in from outside.</p>
	<p>Use caution if working with soil. Wear gloves and wash dirty clothes separately.</p>		<p>Keep pets clean. Wipe off excess dirt and mud before your pet comes inside. Brush and bathe your pet often. Give pets their own beds.</p>

Where to find more information? Ecology wants to keep you informed! There are several ways to get more information about the progress of this project:

- ⇒ Visit Ecology's website (front page) on the latest information page.
- ⇒ Stop by office hours at the Baker Community Center (Tuesday 9 am-noon and Thursday 1-4 pm).
- ⇒ Visit the site signs where flyers will be posted each week. Signs are located at 2901 Butler, 2709 5th St. and the 700 block of Hawthorne.
- ⇒ Call us on the information line at (425) 530-5169 (local Everett number).