

September 18, 1974

Publication No. 74-e38

WA-22-0030

Memo to: Stan Springer and Bob Bottman

From: Grover Scott Jeane II

Subject: The South Aberdeen Junior High School Wood Waste Fill.



The wood waste landfill was visited by myself and Darrel Anderson on July 15, 1974. The seepage observed was minimal due to very dry weather. Stations #2 and #3 were dry. Stations 1 (upstream) and 4 (downstream) were sampled.

Station	D.O.	pH	Temp °C	Sulfides	Cond.	COD	PBI
1	9.5	6.6	12.5	N.D.	65	16	N.D.
4	---	6.2	12.0	N.D.	85	20	N.D.
	NO <sub>3</sub> -N	NO <sub>2</sub> -N	NH <sub>3</sub> -N	TK-N	O-PO <sub>4</sub> -P	T-PO <sub>4</sub> -P	
1	0.12	N.D.	0.04	0.32	0.07	0.40	
4	0.03	N.D.	0.03	0.21	0.03	0.04	?

The dissolved oxygen sample for Station #4 broke in transit. The 9.5 mg/l measured at Station #1 would not have been depressed substantially according to the other water quality parameters. No PBI were measured at either station which seems unusual. The nutrient data does not reveal any problems. All nutrient parameters measured decreased at Station #4. Again this is unusual because the water at Station #4 was noticeably colored by leachate. Sulfides analysis was completed in the field using a LaMotte field kit with none detected at either station. Future sampling is tentatively being scheduled in conjunction with the Chehalis River Basin Study.

GSJ:jmh

# STATE OF WASHINGTON DEPARTMENT OF ECOLOGY

WATER QUALITY LABORATORY

ORIGINAL TO:  
G.S. JEANE.....  
COPIES TO:  
B. BRYMAN.....  
.....  
LAB FILES.....

## DATA SUMMARY

Source Cosmopolis Landfill

Collected By G.S.J.

Date Collected 7-15-74

Goal, Pro./Obj. \_\_\_\_\_

Log Number:	74.	2892	93										STORET
Station:	1	4											
pH	7.1	6.7											00403
Turbidity (JTU)													00070
Conductivity (umhos/cm)@25°C	64.	85.											00095
COD	16	20											00340
BOD (5 day)													00310
Total Coliform (Col./100ml)													31504
Fecal Coliform (Col./100ml)													31616
NO3-N (Filtered)	.12	.03											00620
NO2-N (Filtered)	ND	ND											00615
NH3-N (Unfiltered)	.04	.03											00610
T. Kjeldahl-N (Unfiltered)	.32	.21											00625
O-PO4-P (Filtered)	.07	.03											00671
Total Phos.-P (Unfiltered)	.40	.04											00665
Total Solids													00500
Total Non Vol. Solids													
Total Suspended Solids													00530
Total Sus. Non Vol. Solids													
PBI	ND	ND											

Note: All results are in PPM unless otherwise specified. ND is "None Detected"  
Convert those marked with a \* to PPB (PPM  $\times 10^3$ ) prior to entry into STORET

Summary By Stephen D. Roll Date 8-23-74

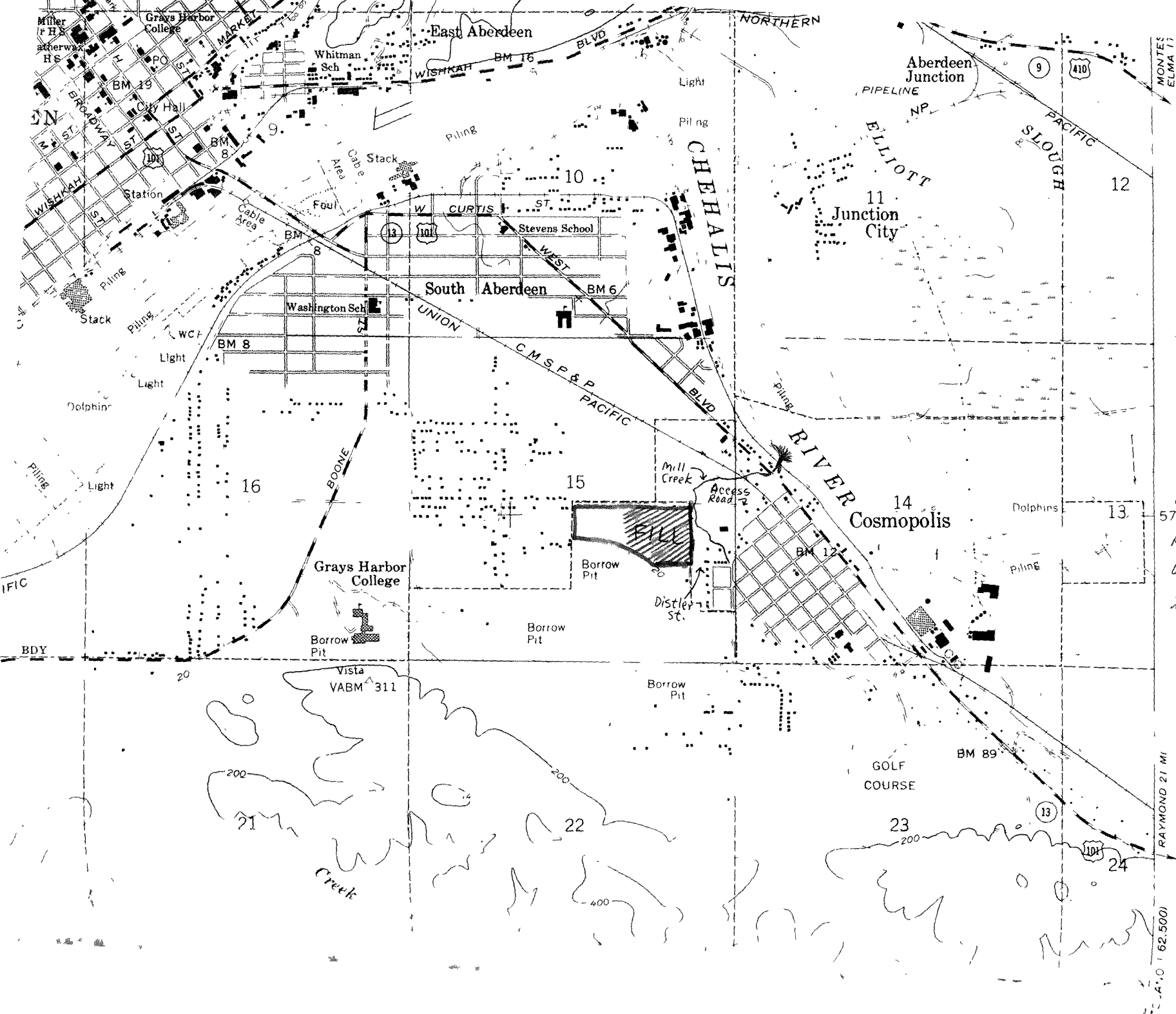

Scott if access  
road is closed,  
you can get  
onto fill by  
parking at the  
west end of  
Distler St. and  
walk out on  
the fill.  
Bob B.

Scott: this sketch is not to scale, but gives relative locations of sampling points

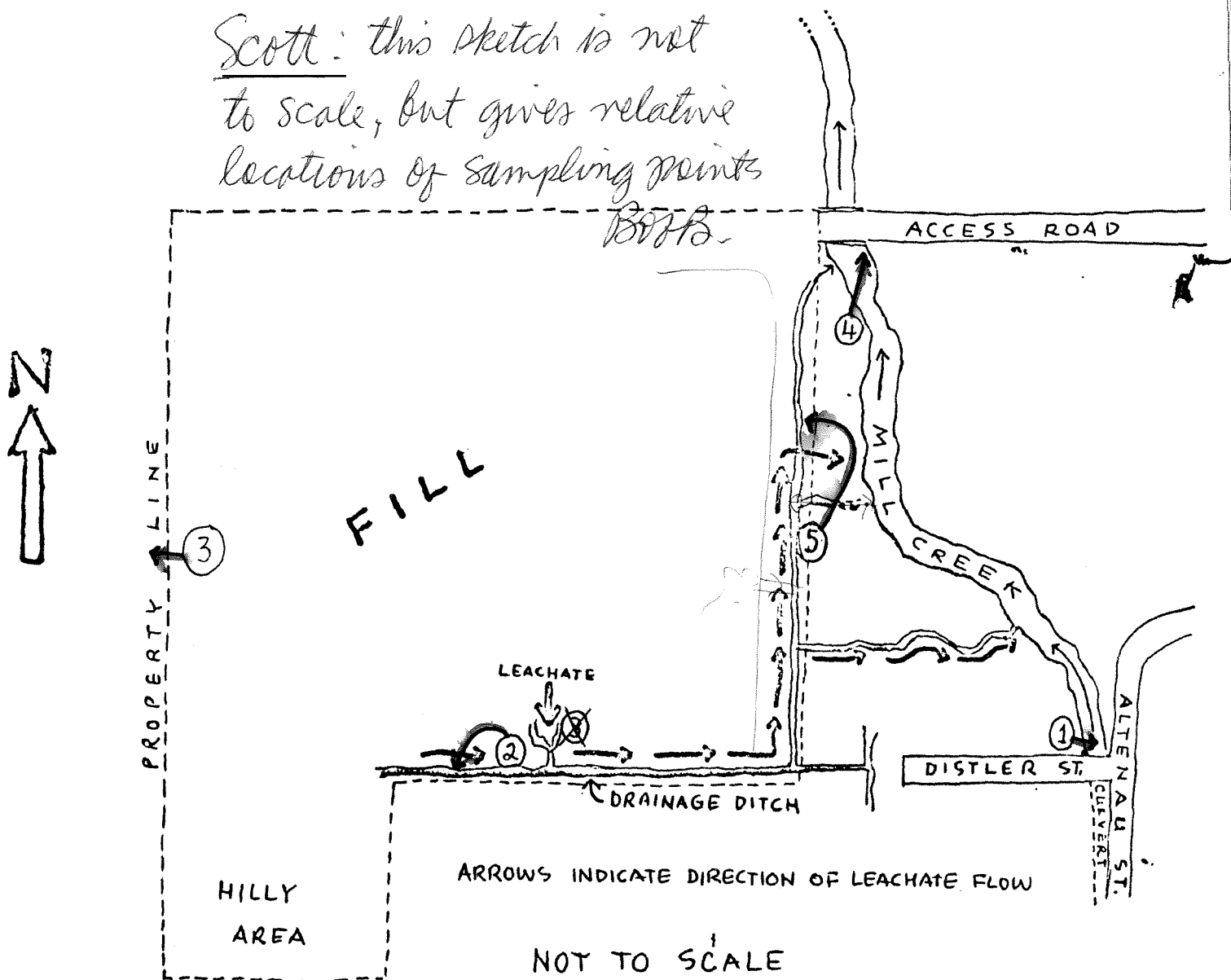

Red arrows indicate sampling points used on October 18, 1973.

APRIL 4, 1973

<u>STATION</u>	<u>LOCATION</u>
1	MILL CREEK ABOVE LEACHATE INFLUENCE AT DISTLER ST. AND SOUTH ALTENAU.
2	IN DRAINAGE DITCH ABOVE LEACHATE INFLUENCE,
3	<del>LEACHATE</del> DRAINAGE DITCH ON WEST EDGE OF FILL.
4	MILL CREEK BELOW LEACHATE INFLUENCE.
5	IN DRAINAGE DITCH BELOW LEACHATE INFLUENCE AND BEFORE ENTRY INTO MILL CREEK.

# DEPARTMENT OF ECOLOGY

WATER QUALITY LABORATORY

ORIGINAL TO: B. BOHMAN.....  
COPIES TO: M. PRICE.....  
.....  
LAB FILES.....

## DATA SUMMARY

Source Bell Dev. Co. Wood Waste Fill (SW) Collected By B. B.

Date Collected 10-18-73 Goal, Pro./Obj. \_\_\_\_\_

Log Number: 73-3846 42 48 49 50 STORET

Station:	1	2	3	4	5						
pH	6.8	7.4	5.8	6.6	5.4						00403
Turbidity (JTU)	2	5	2	3	3						00070
Conductivity (umhos/cm) @ 25°C	72.	104.	170.	130.	650.						00095
COD	11	19	180	27	740						00340
BOD (5 day)			14		420						00310
Total Coliform (Col./100ml)											31504
Fecal Coliform (Col./100ml)											31616
NO3-N (Filtered)											00620
NO2-N (Filtered)											00615
NH3-N (Unfiltered)											00610
T. Kjeldahl-N (Unfiltered)											00625
O-PO4-P (Filtered)											00671
Total Phos.-P (Unfiltered)											00665
Total Solids	84	115	242	93	636						00500
Total Non Vol. Solids	38	57	99	70	300						
Total Suspended Solids	19	16	10	18	55						00530
Total Sus. Non Vol. Solids	10	8	3	6	13						
Color	90	56	1020	160	820						
PBI	9	14	340	59	2900						
DISSOLVED OXYGEN	10.9	10.6	1.3	9.3	0.5						

Note: All results are in PPM unless otherwise specified. ND is "None Detected"  
Convert those marked with a \* to PPB (PPM X 10<sup>3</sup>) prior to entry into STORET

Summary By Stephen D. Hall Date 11-1-73

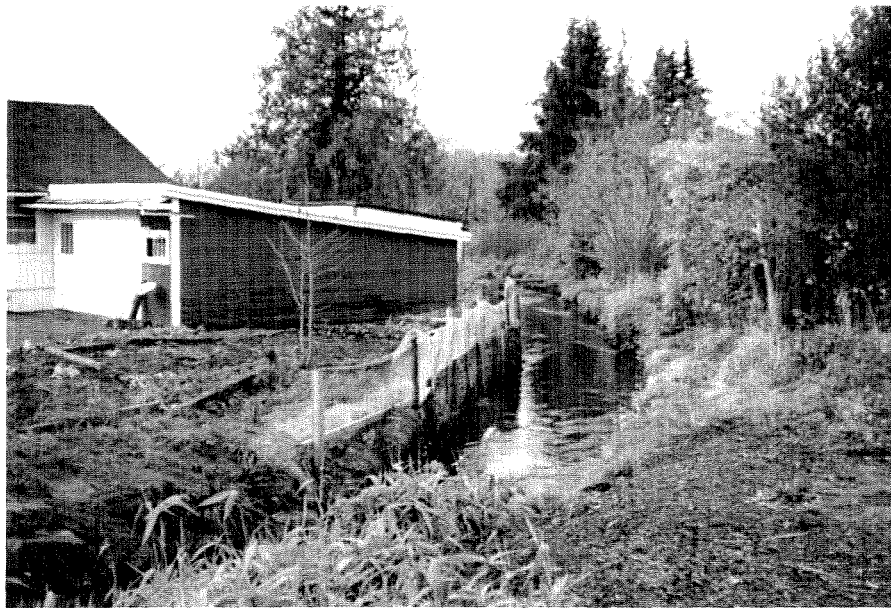

Sample point 1. Looking downstream on mill Creek from Distler St. (This is above the influence of leachate from the pile.)



Sample point 2. (Down the influence of leachate from the pile) Looking downstream on mill Creek from the north end of Distler St.